

For more detailed installation instructions visit www.diodeled.com.

Max. Amp	12V - 5A / 24V - 4A	Wire Gauge	14 AWG - 20 AWG*
-----------------	---------------------	-------------------	------------------

*Stranded, not tinned wire only. If utilizing 14AWG solid or tinned wire, replace stock screws with included alternates.

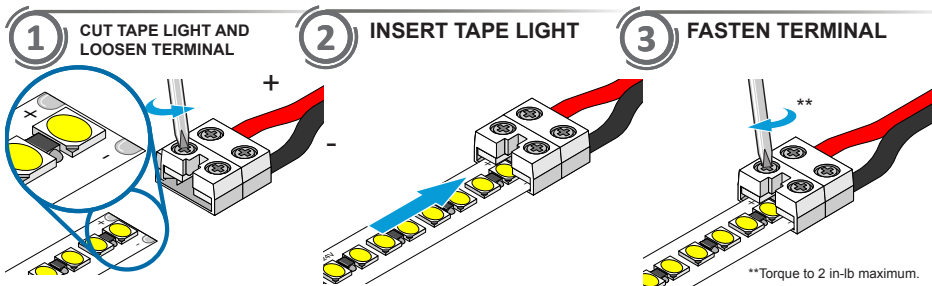

Toll Free: 877.817.6028 | Fax: 415.592.1596 | www.DiodelLED.com | info@DiodelLED.com

© 2019 Elemental LED Inc. All rights reserved. Specifications are subject to change without notice.