

# INSTALLATION MANUAL

PRODUCT PARAMETER	
INPUT VOLTAGE	120 - 277V
RATING	IP65, WET LOCATION
CONTROL	0 - 10V, DC PHOTOCELL - REMOVEABLE



### SAFETY INFORMATION

**BE SURE THE POWER IS OFF! RISK OF ELECTRICAL SHOCK:** Always use the switch to power off. Do not perform any operations while this unit is powered on. The electrical system you want to connect the device to must be grounded. Read the instructions before using or powering this device. The safety instructions must remain with the unit in case of transfer. Any damage to the device linked to an inappropriate use is excluded from support by the warranty. Before connecting, make sure that the current and voltage are compatible with this device. We highly recommend that all installations are made by QUALIFIED ELECTRICIAN. We are NOT responsible by any means for the use or misuse of the following information. We are NOT responsible in whole or part for any harm or damage that may or may not be caused. We reserve the right to revise the components of any product, due to part availability or change ETL, CUL, UL standards without assuming any obligation or liability to modify any products previously manufactured and without notice. These instructions do not cover all details of variations in equipment, nor do they provide every possible contingency to be met. Turn off / unplug power when installing or service device.

### PRE - INSTALLATION

- Carefully remove the fixture from the carton.
- Before beginning assembly, installation, or operation of product, make sure all parts are present. Compare parts with package contents list and diagram on previous page. If any part is missing or damaged, do not attempt to assemble, install or operate the product. Contact customer service for replacement parts.
- Tools required for assembly (Not Included): screwdriver, phillips screwdriver, pliers, electrical tape, wire cutters, safety glasses, ladder, wire stripper.

### WARNING

- WARNING:** Read all safety precautions and installation instructions carefully before installing or servicing this fixture. Failure to comply with these instructions could result in a potentially fatal electric shock, fire, and/or property damage.
- To prevent personal injury or product damage only licensed electricians should install.
  - To avoid electric shock or component damage disconnect power before attempting installation or servicing.
  - This product must be installed in accordance with the national electrical code (NEC) and all applicable federal, state and local electric codes and safety standards.
  - Disconnect product and allow cooling prior to servicing.
  - Any alteration or modification of this product is expressly forbidden as it may cause serious personal injury, death, property damage and/or product malfunction
  - To prevent product malfunction and/or electrical shock this product must be properly grounded.
  - This luminaire is designed to operate in ambient temperatures ranging from -22°F ~ 113°F

## INSTALLATION (Caution: Before beginning installation turn off the circuit breaker and light switch)

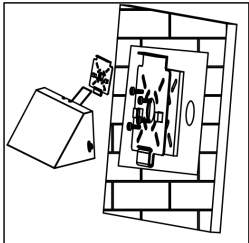

**STEP 1**  
Remove the lamp and hook from the mounting plate and fix the mounting plate and waterproof foam on the wall.

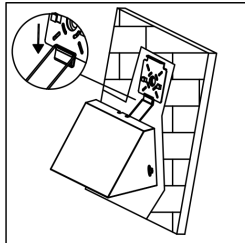

**STEP 2**  
Hang the lamp on the mounting plate.

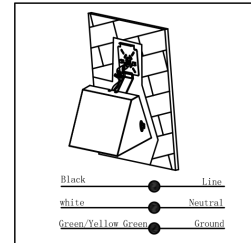

**STEP 3**  
Connect the AC line of the lamp.

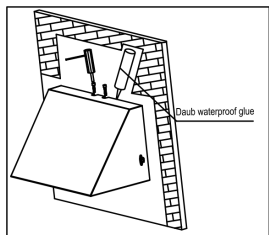

**STEP 4**  
After hanging the lamp on the mounting plate and tightening the screws, and put a waterproof glue seal between the bottom cover and wall to prevent water from entering the lamp.

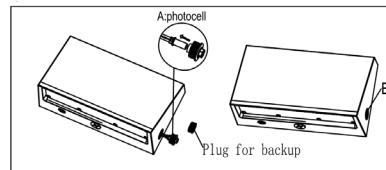

**STEP 5**  
If the user feels that the light control probe exposed by the bulge of the lamp is not beautiful and does not need the light control function, you can unscrew the light control plug as shown in Figure A. Pull out the probe black rubber plug inside the plug and put it back into the lamp to replace the spare flat plug and tighten, as shown in figure B

### CCT & Wattage Adjustable and Microwave installation instructions

