

LS1 direct

>90 CRI
up to
125
lumens / watt

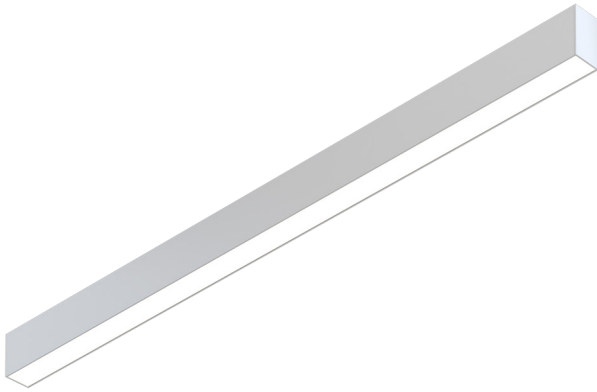

The LS Series of architectural luminaires offers a wide range of profiles and mounting options. Custom lengths and patterns are tailored to suit any modern space.

Features

- Living Building Challenge Declare listed. Red List Free optional.
- Extruded recycled aluminum housing
- Aluminum core LED boards, specifiable optics
- Specifiable color temperature. CRI > 90, R9 > 70
- Custom lengths, welded patterns, and finishes available
- Integral specifiable dimmable drivers or PoE
- 5 Year, 50,000 hour warranty, damp location rated
- WELL Building Standard compatible [learn more](#)

Dimensions

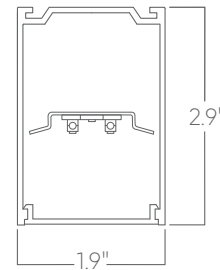

Optics

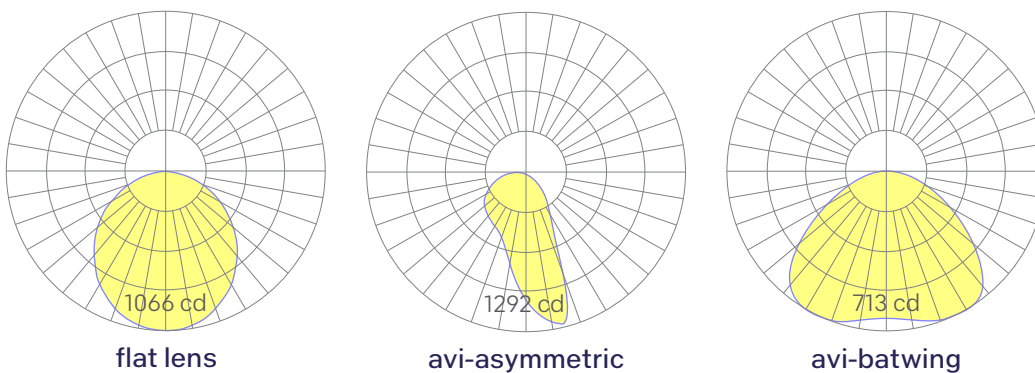

Representative distribution and peak candela. For other options see order information or IES files [here](#).

Modification date: January, 2026

Page 1 of 4

LS1 direct

Ordering Information

For each option group below specify one option. If you don't see your preferred option listed, contact us for [help](#).

1	Fixture ID	2	Length	3	Color Temperature	4	Output
LS1		2	2 ft	27	2700K/90 CRI	LOW	Low output
		4	4 ft	30	3000K/90 CRI	MED	Medium output
		8	8 ft	35	3500K/90 CRI	HIGH	High output
		XX	Specify length	40	4000K/90 CRI	CUST	Custom output
		PAT	Pattern Submit drawing.	50	5000K/90 CRI		Specify watts or lumens: Up to 13W/ft max. Down to 6W/driver min.
				TW	Tunable White 2700K-6500K Must use TW10 driver		
				RGBW30	RGB +white; 3000k Must use remote DMX driver		
				RGBW35	RGB +white; 3500k Must use remote DMX driver		
				RGBW40	RGB +white; 4000k Must use remote DMX driver		
				WD	Warm Dim 2200K-3000K Must use WD10 driver.		
5	Voltage	6	Driver	7	Finish	8	Mounting*
UNV	Universal (120/277V)	DB	Standard 0-10V 1%	W	White	AC	AC cable (50 in.)
347V	347V	DB.1%	0-10V 0.1%	BLK	Black	ACCC	AC cable To conduit pipe canopy.
		ELV	Reverse phase 1% (120V only)	CC	Custom color See finish options here	ACTB.X	Aircraft cable to Tbar clip Specify 9/16th, 15/16th, or Slot.
		TRI	Forward phase	CWF	Custom wood finish See finish options here	AC3.5	3.5 in. canopy + Jbox adaptor Adaptor must be mudded-in.
		LDE1	Lutron Digital EcoSystem	SLV	Silver	PS.X	Pendant stem 12, 18, 24, 36, or 48 in. Consult factory for lengths not shown.
		JA8	JA8 compliant 1% dimming			PSFC	Field cuttable pendant stem 94 in. stem field cuttable to any length
		DALI	DALI-2 driver			SMHC	Surface mount hard ceiling
		PoE	Power over ethernet			SMTB.X	Surface mount to Tbar clip Specify 9/16th, 15/16th, or Slot.
		TW10	2 channel 0-10V for tunable white			WM	Wall mount
		WD10	0-10V warm dimming				
		DMX	DMX512 All DMX drivers set to default address 001 and provided in remote enclosers. Contact us for other addressing needs.				
9	Optics	10	Sensors/Controls	11	Circuit	12	Options
FL	Flat diffuser	NA	None	NA	None	NA	None
AVI.ASY	Asymmetric optic	WISM_%	Wattstopper occupancy	EMPCK	Emergency battery pack	STD	White Canopy + white cord
AVI.BWG	Batwing optic	WISD	Wattstopper daylight	EMCKT	Emergency circuit May require additional power feeds	CAN.X	Canopy + color See finish options here
		ACM	Acuity nLight- module only	DAYCKT	Daylight circuit May require additional power feeds.	SJ.BLK	Black cord
		ACS	Acuity nLight- (nES 7)			SJ.WHT	White cord
		ACAS	Acuity nLight- AIR (rES 7)			RLF	Red List Free
		CCS	Casambi module				
		AWN.R	Lutron Athena wireless node				
		AWN.S	Lutron Athena wireless node with sensor				
		OTHER	Consult factory				
		ACAM	Acuity nLight Air (r10)				

Performance

Output ¹	Watts/ft	Lumens/ft	LPW
Low	3.5	436	125
Medium	5.5	689	125
High	7.5	938	125

¹Based on a typically configured 90 CRI, 3500K luminaire using one driver.
Custom outputs available. Please consult factory.
For 4000K multiply by 1.05; for 3000K, 0.96; for 2700K, 0.92.
For Warm Dim multiply by .80.

Technical Information



click [here](#) or
scan QR code

Wiring diagrams, PoE and sensor details

Modification date: January, 2026

Page 2 of 4

LS1 direct

Drivers & Electrical

Integral drivers* with 0-10V Dimming standard. Several other driver options available; see ordering information.

*DMX drivers are provided in remote enclosures.

Sensors & Controls

Sensors are installed on an aluminum plate adjacent to the luminaire lens¹. Coronet remains agnostic in our approach to sensors and control systems; our fixtures are compatible with most systems offered.

¹Not applicable to indirect only models. Consult factory.

Emergency Back-Up

For fixtures three-feet or longer, a 6W emergency driver may be wired to 4ft sections. A 10W driver is also available (consult factory). Emergency circuits for use with building generators are also available.

PoE (Power over Ethernet)

Compatible with virtually all PoE systems including Molex Coresync, Smartengine, Platformatics, and NuLED SPICEbox.

Consult factory for systems not listed. See [here](#) for more info.

Finishes

All luminaires are finished in high quality polyester powder coating. Our standard color is white. Any RAL color may be specified.

Weight

3 lbs per foot

Optics

Extruded satin acrylic lenses provide excellent diffusion, high transmission, and no LED imaging.

Construction

Housings are extruded premium, recycled aluminum. Individual fixtures are available up to 12' long and may be specified as nominal or precision lengths. Precision lengths are supplied within 1/8" tolerance.

Joined Runs

Runs of any length may be specified and are comprised of multiple, factory-engineered, joined sections. Individually specified luminaires are not field joinable.

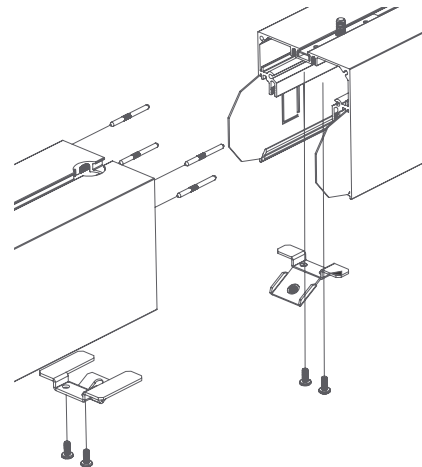

Representative joinery. For product specific details see installation guides or submittal drawings.

Patterns

Featuring illuminated welded corners and angles. Consult factory for custom designs and elevations.

Square



X



T



V



Custom

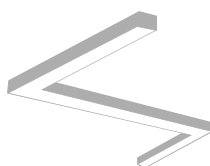

Elevation

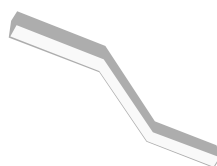

Wall/Ceiling

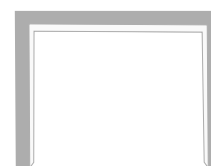

Mounting Options

Custom mounting types and ceiling transitions available; consult factory.
Mounting and power feed locations will be added to approval drawings by request.

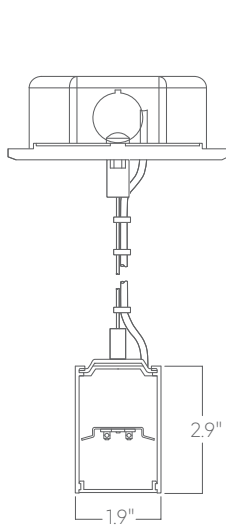

**Aircraft cable
5" canopy**

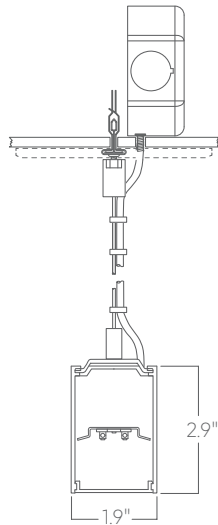

**Aircraft cable
5" canopy, T Bar Clip**

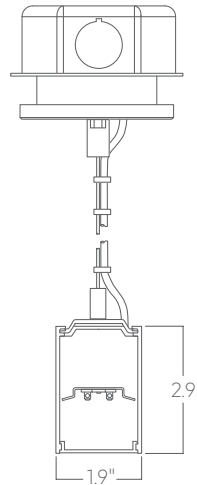

**Aircraft cable
3.5" canopy**

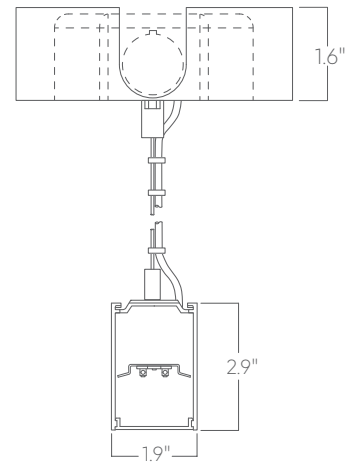

**Aircraft cable
Conduit canopy
with knockouts**

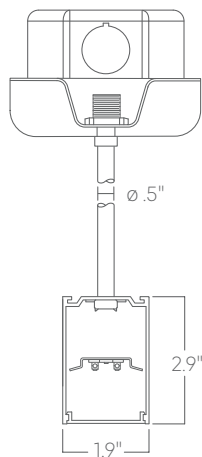

Pendant stem

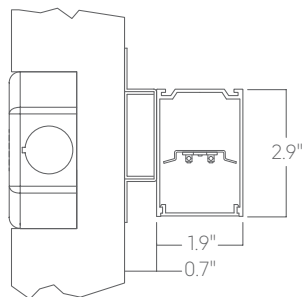

Wall mount

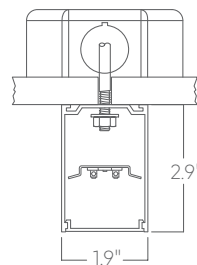

**Surface mount
Hard Ceiling**

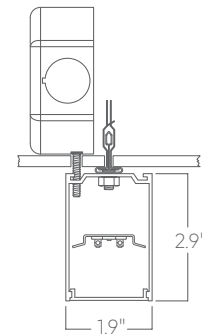

**Surface mount
T Bar Clip**

To prevent damage to fixtures, factory designated suspension points must not be field altered.
Do not attempt installation if you do not understand the installation instructions.